

The Big Containment Pac™ (BCP) couples the power of the Inflatable Containment Tank™ (ICT), with an Andax Emergency Spill Pac™ for up to 110-gallons of spill containment – all in an 15" x 18" x 5" package. It's small enough to easily fit in narrow spaces, like behind a truck seat, utility compartment or toolbox. The BCP is a revolutionary, complete solution with everything you need to contain spills quickly.

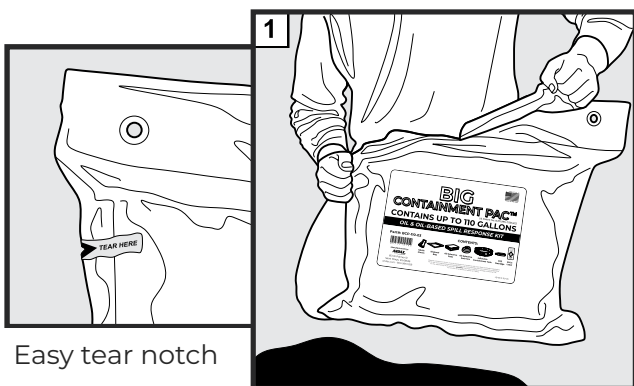

Pull the Big Containment Pac™ out from behind the seat of a truck or small storage area.



Easy tear notch

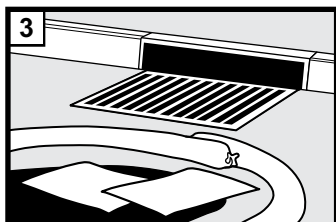
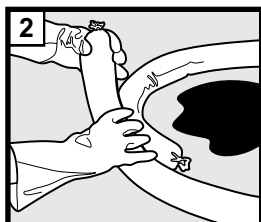
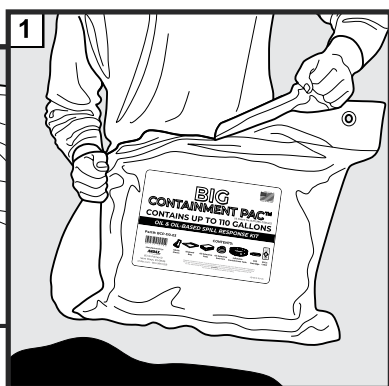

Suggested Use

1. Open Pac by pulling at tear notch located under heat seal at top of Pac. Remove contents and use the included personal protective equipment.

Position and deploy the ICT under the source of the leak or spill. (follow instructions on back)

2. Use contents of the spill kit to block off any storm drains, water ways or environmentally sensitive areas or as needed.

3. Place absorbent pads over spill. When finished, put contaminated materials into the supplied temporary disposal bag.

Report incident to your company and the appropriate local, state, or federal agencies. The spill pac is an emergency response measure for minor spill containment and clean-up. Due to the possible toxic and/or hazardous materials absorbed, Andax Industries LLC does not recommend disposal procedures. Dispose of soiled contents in accordance with local, state and federal regulations. The ICT is reusable if not used to contain toxic or hazardous materials. Visit andax.com/document/andax/ICTChemicalCompatibility.pdf for a full compatibility list.

Contents:



Gloves

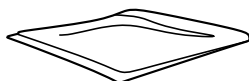

Disposal Bag

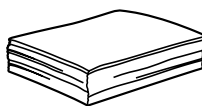

Pads



Sox

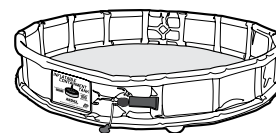

ICT - Inflatable pool

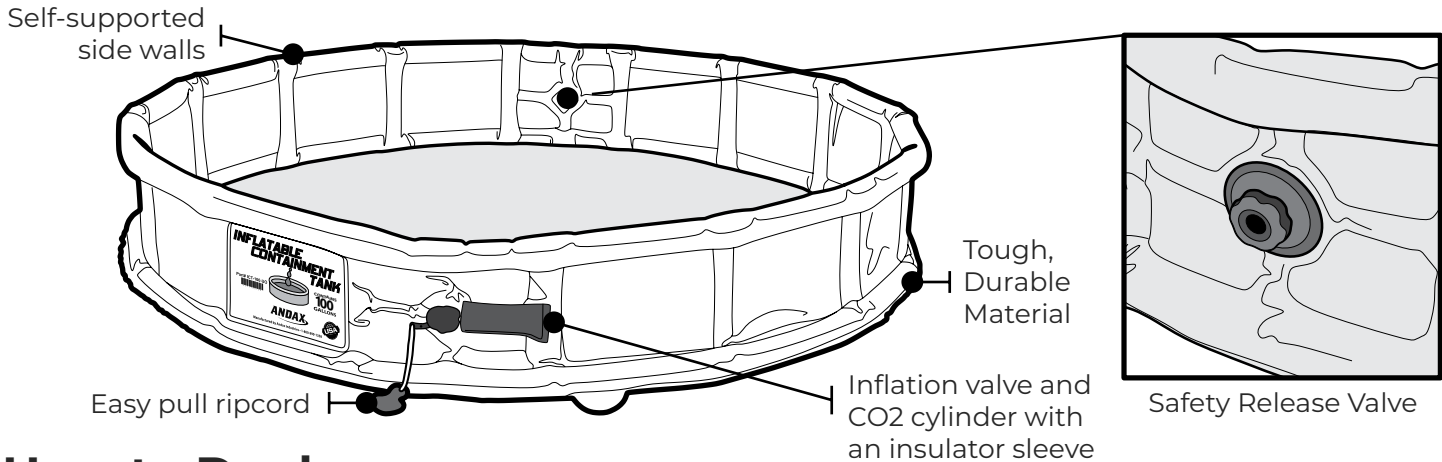

How to Deploy

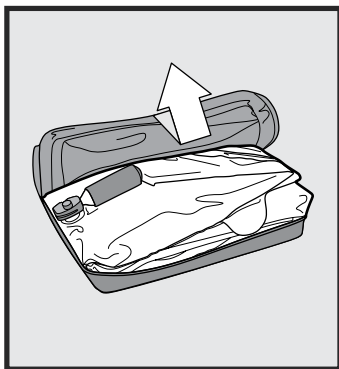

Unzip the compact carrying case and remove the pool.

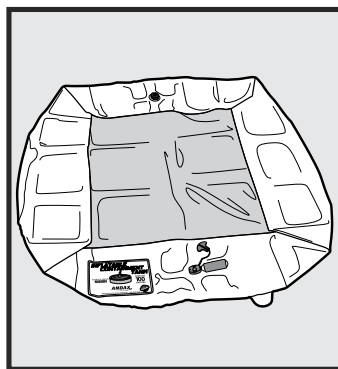

Unfold the pool on level ground with the inflation valve nearest you and facing up.

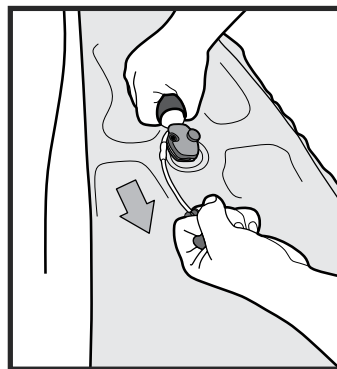

Grip the CO2 cylinder with the insulator sleeve and pull the red handled ripcord on the Inflation valve to activate the CO2 cartridge.

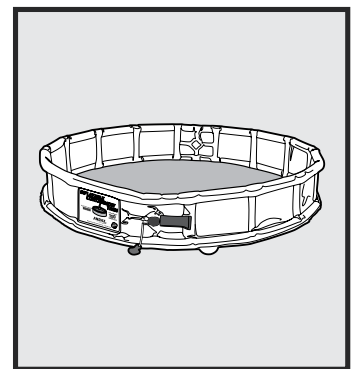

Once the CO2 cartridge is activated, the pool will inflate in seconds. Adjust the pool to capture the leak. Use the supplied protective gloves as needed.

How to Fold

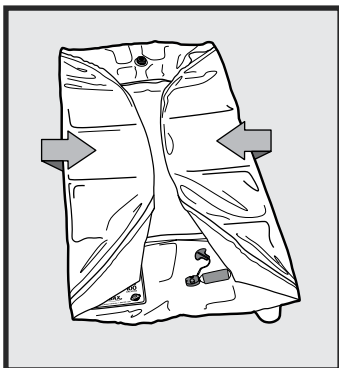

Open the safety release valve to deflate the pool. When the air has been removed, close the safety release valve. Fold sides without overlapping.

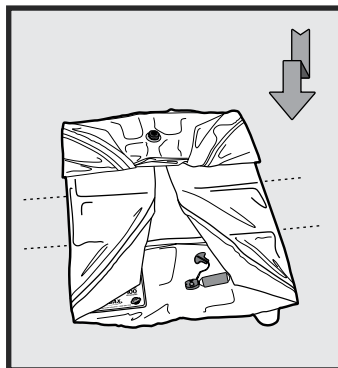

Begin folding the pool from top to bottom into fourths.

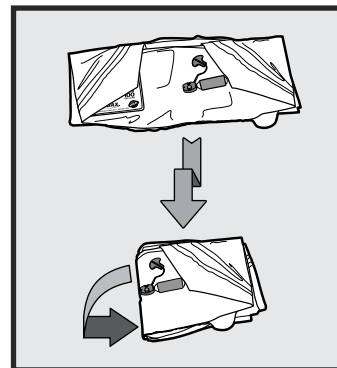

Continue folding with the inflation valve on top then fold in half.



Purchase a replacement cylinder and store the pool inside its soft carrying case.